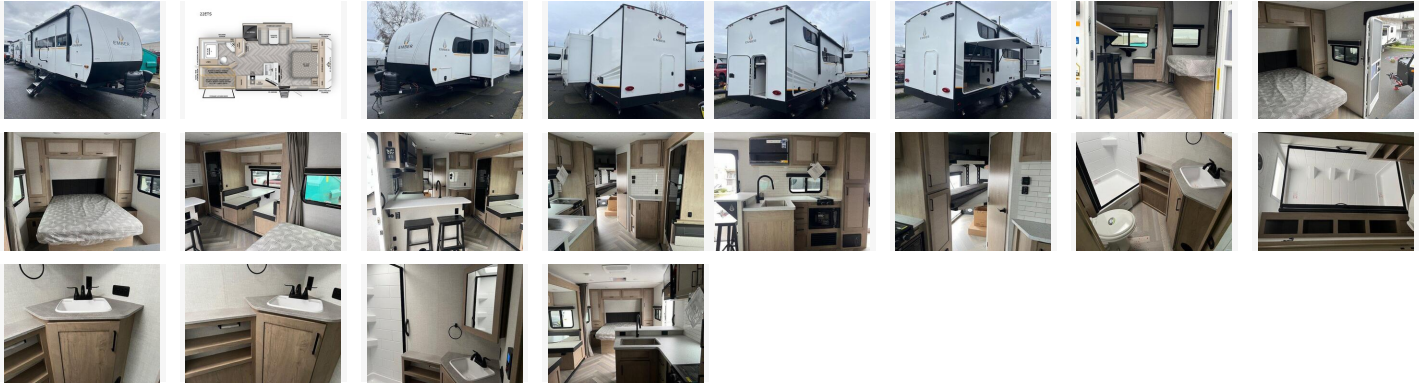

2024 E-Series 22ETS

\$50,004

Item

Item URL: <https://www.rvpostings.com/377201> **Item reference number**
#377201

Dealer

RV Country Fife
Phone: 253-200-1085
Email: import34@rvcountry.com

Quick info

0 mi

Details

Item type: For sale
Posted on : 05/02/2021

2024 E-Series 22ETS

\$50,004

Description

New 2024 Ember RV E-Series 22ETS Ember RV E-Series travel trailer 22ETS highlights: Semi-Private Bedroom Coffee Hutch 10 Cu. Ft. 12V Refrigerator Exterior Storage Locker Door Single/Double Bunk Configurations You'll love every minute spent in this spacious travel trailer that can sleep up to six. The patent-pending repositionable EmberTrack E-Track bunk/storage system includes 74" x 45" cargo space, and there are multiple single/double bunk configurations to fit your needs. The front walk-around true residential queen bed includes dual nightstands and dual wardrobes, plus a privacy curtain if you have guests staying over. This E-Series kitchen includes an air fryer convection microwave, a two burner cooktop, plus a breakfast bar with bar stools so you can visit with the chef as they cook meals. A legless dinette slide will provide a place to dine, or you can take your plate outdoors to sit under the 14' power awning with a dimmable LED light. You'll also find a pass-through storage outside, along with a docking station and a kayak/bike storage door! With any E-Series travel trailer by Ember RV you will enjoy a lightweight RV with all the "Essentials" needed for memorable trips in the great outdoors! Each model is constructed with durable laminated Azdel Onboard composite walls, a full walkable roof with a one-piece Tufflex PVC roofing material, and a gel-coated fiberglass exterior. The Dexter axles with E-Z lube hubs and forward self-adjusting electric brakes plus Goodyear Endurance tires will provide a smooth tow from home to campground. You will appreciate the Congoleum DiamondFlor "carpetless" interior that is easy to clean, and the hardwood framed cabinet doors will create a more residential feel. Each model includes a tankless on-demand water heater for endless hot showers and an 18,000 BTU Max Cool "Whisper Quiet" A/C, which is the largest single A/C in its class! An EmberLink Smart RV system will let you easily control features such as lights and slides and you can wash away those rainy day blues by watching the HDTV with a built-in Bluetooth AV system. If you're looking for off-grid capabilities, you might want to choose the optional Off-Grid Solar Package with 400 total watts of solar panels, a 2,000W Pure Sine wave inverter, and a Victron MPPT solar controller! Front Bedroom|Bunkhouse

Basic information

Year: 2024
Stock Number: 42428
VIN Number: fife-42428
Condition: New
Length: 325
GVW: 6995
Sleeps: 6
Slideouts: 1

Item address

[5111 20th Street East, 98424, Fife, Washington, United States](#)

2024 E-Series 22ETS

\$50,004

Item images

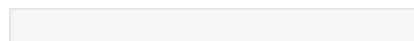
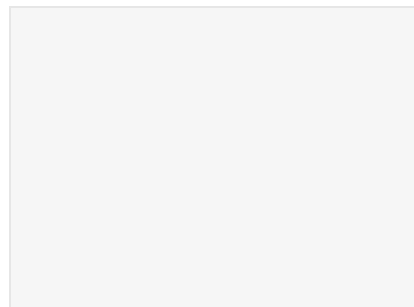
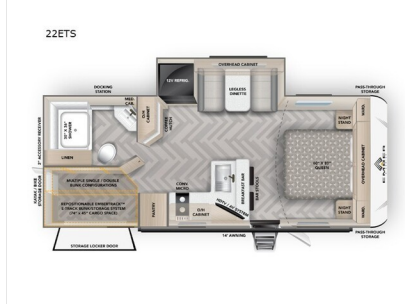

2024 E-Series 22ETS

\$50,004

