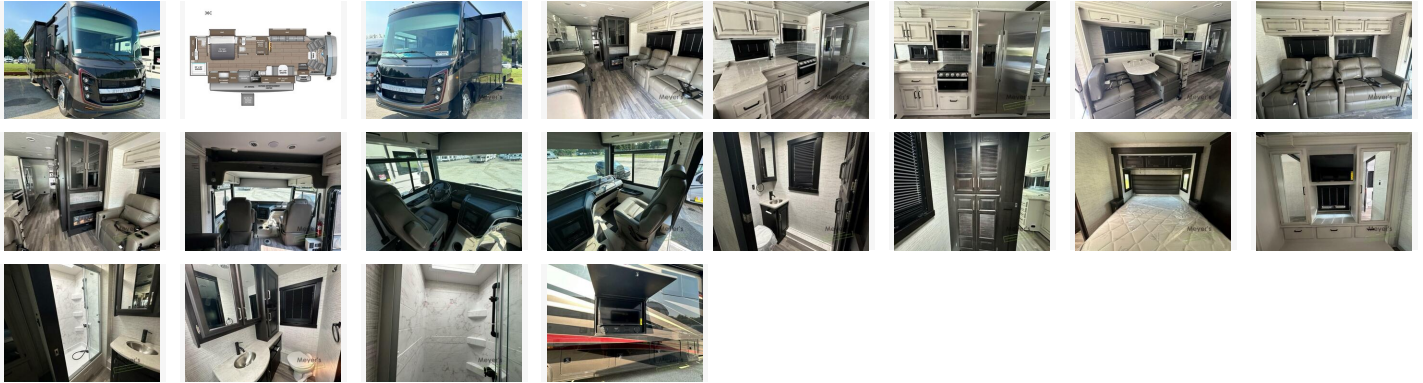

2024 Entegra Coach Vision XL 36C

\$245,822

Item

Item URL: <https://www.rvpostings.com/325767> **Item reference number**
#325767

Dealer

Meyer's RV Superstore - Pittsburgh
Phone: 7244262392
Email: import237553@rvpostings.com

Quick info

0 mi

Details

Item type: For sale
Posted on : 10/31/2022

2024 Entegra Coach Vision XL 36C

\$245,822

Description

2024 Entegra Coach Vision XL 36C, Entegra Coach Vision XL Class A gas motorhome 36C highlights: Master Suite Full and Half Bath Full-Wall Slide Theater Sofa Tri-Fold Sofa Fireplace Picture yourself sitting in one of the swivel cab seats with your favorite beverage resting on the removable cockpit table in this Vision XL Class A gas motorhome! When you enter this coach, you will be greeted with a warm and comfortable living environment that has a theater sofa, hide-a-bed sofa, and 38" x 70" booth dinette for lounging, and the fireplace and 50" LED HD Smart TV will add to the coziness. For storing your favorite foods, you can use the residential refrigerator and pantry, and your dishes can be kept in the hutch or overhead cabinets. Conveniently located across from the kitchen is the half bathroom which has an area prepped for an optional washer/dryer, and the walk-around king-size bed in the master suite creates an exceptionally comfortable space to spend your nights. Trips have never been easier to plan than with the Entegra Coach Vision XL Class A gas motorhome! Since the Vision XL comes with just about anything you could need while you're out and away, you'll always feel like you're right at home. These coaches have been expertly crafted with the E-Z Drive Elite package, so you can experience the smoothest ride, and the construction is absolutely reliable with its TuffShell vacuum-bond laminated sidewalls and floor, bead-foam insulation, and one-piece, seamless crowned fiberglass roof. Before you take off, pack up the lockable pass-through storage compartments with your totes and travel gear, and then head to the cockpit where you can use the backup and sideview cameras to maneuver easily out of the driveway. The kitchen is both attractive and useful with its LED-lit, solid-surface countertops, decorative backsplash, and recessed stainless steel sink, and the water filtration system will make it easy to stay hydrated. CUSTOMER VALUE PKG; CUSTOMER VALUE PKG DISC; FORAKER PAINT; MODERN FARMHOUSE; OVERHEAD BUNK

Basic information

Year: 2024
Stock Number: 61716
VIN Number: 1F66F5DN8P0A01535
Condition: New
Length: 38
GVW: 24000
Sleeps: 5
Slideouts: 3

Item address

[, Apollo, Pennsylvania, United States](#)

2024 Entegra Coach Vision XL 36C

\$245,822

Item images

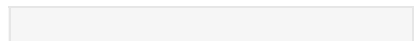
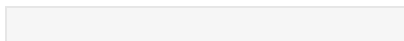
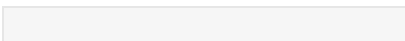
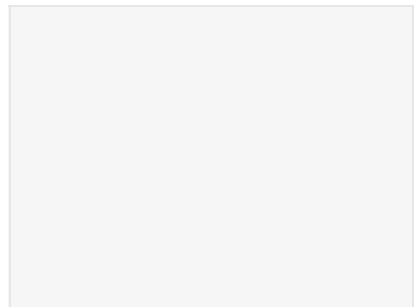
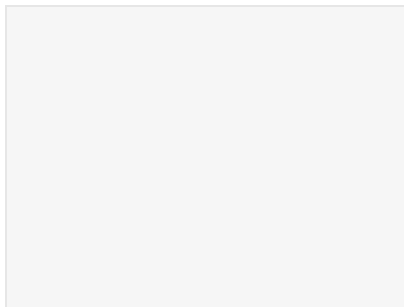
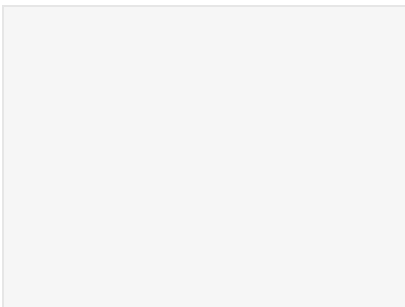
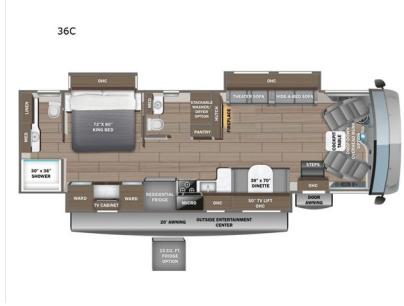

2024 Entegra Coach Vision XL 36C

\$245,822